

PAD EYES TYPE S

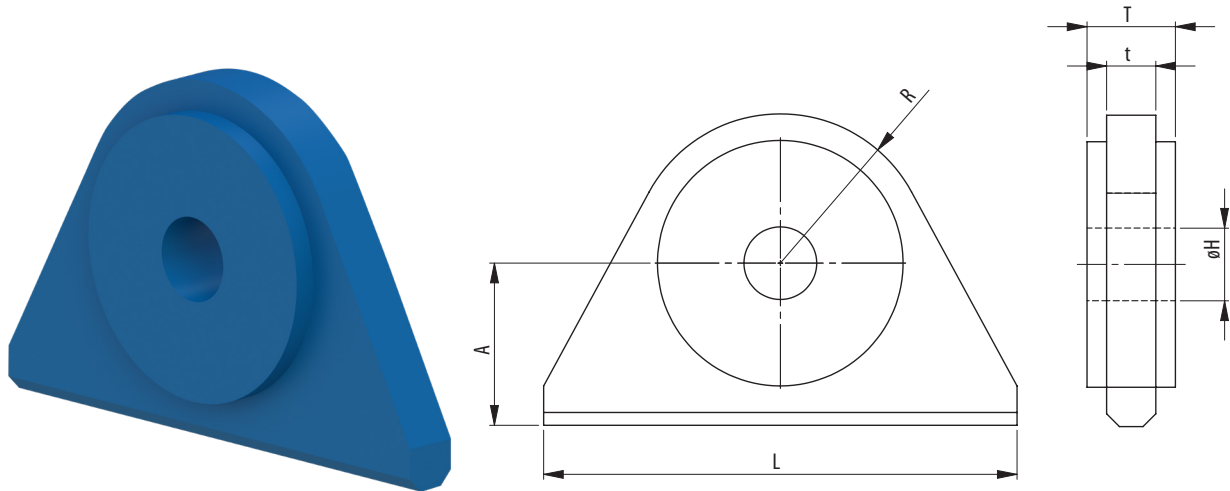

| Model No. | Shackle size | WLL (UStons) | Dimensions (inch) | | | | | | Weight (lbs) |
|----------------|--------------|-----------------|-------------------|-------|------|-------|------|------|-----------------|
| | | | L | A | øH | R | t | T | |
| PE 14.11,5.1 | 3/8 | 1.1 | 2.99 | 1.26 | 0.45 | 1.02 | 0.55 | 0.55 | 0.7 |
| PE 15.13,5.1,5 | 7/16 | 1.7 | 3.54 | 1.26 | 0.53 | 1.26 | 0.59 | 0.59 | 1.1 |
| PE 18.17.2 | 1/2 | 2.2 | 3.94 | 1.50 | 0.67 | 1.38 | 0.71 | 0.71 | 1.5 |
| PE 22.20.3,25 | 5/8 | 3.6 | 4.53 | 1.77 | 0.79 | 1.50 | 0.87 | 0.87 | 3.3 |
| PE 25.23.4,75 | 3/4 | 5.2 | 5.51 | 2.01 | 0.91 | 1.77 | 0.98 | 0.98 | 4.4 |
| PE 30.26.6,5 | 7/8 | 7.2 | 5.91 | 2.24 | 1.02 | 2.01 | 1.18 | 1.18 | 6.6 |
| PE 35.29,5,8,5 | 1 | 9.4 | 7.09 | 2.52 | 1.16 | 2.52 | 1.38 | 1.38 | 11 |
| PE 40.33,5,9,5 | 1 1/8 | 10.5 | 7.99 | 2.99 | 1.32 | 2.99 | 1.57 | 1.57 | 17 |
| PE 45.37.12 | 1 1/4 | 13.2 | 8.50 | 3.27 | 1.46 | 3.27 | 1.77 | 1.77 | 22 |
| PE 50.40.13,5 | 1 3/8 | 14.9 | 8.98 | 3.50 | 1.57 | 3.50 | 1.18 | 1.97 | 22 |
| PE 50.44.17 | 1 1/2 | 18.7 | 11.02 | 5.51 | 1.73 | 4.02 | 1.57 | 1.97 | 40 |
| PE 60.53.25 | 1 3/4 | 27.6 | 12.01 | 5.51 | 2.09 | 4.76 | 1.57 | 2.36 | 51 |
| PE 70.60.35 | 2 | 38.6 | 14.02 | 6.02 | 2.36 | 5.24 | 1.97 | 2.76 | 77 |
| PE 90.74.55 | 2 1/2 | 60.6 | 18.98 | 6.50 | 2.91 | 5.98 | 1.97 | 3.54 | 121 |
| PE 110.87.85 | 3 | 93.7 | 22.01 | 7.99 | 3.43 | 7.01 | 2.36 | 4.33 | 198 |
| PE 120.100.120 | 3 1/2 | 132.3 | 27.99 | 10.00 | 3.94 | 9.02 | 2.76 | 4.72 | 375 |
| PE 150.114.150 | 4 | 165.3 | 32.01 | 11.02 | 4.49 | 10.00 | 3.15 | 5.91 | 551 |

Minimum Ultimate Strength = 6 x WLL

- Pad eyes will be supplied including material certificates (S355J2G3, EN 10204 3.1)
- $T \geq 75\%$ of inside width of shackle.
- $H \leq 106\%$ of diameter of pin.
- Well primer applied

