

TURNBUCKLES WITH TRAPEZOID THREAD

Ropeblock's standard turnbuckles allow for working loads ranging from 1 to 160 tons. They are available in all possible combinations of jaws, round eyes and oval eyes (no stub ends!). In standard design, the dimensions of the trapezoid thread turnbuckles generally are in accordance with NEN 3305.

Standard features include:

- Standard finish: primer coating blue RAL 5017. Other finishes, including coatings in accordance with ISO 12944 specifications, are available on request.
- Standard with locking nuts. Locking plates, locking bolts and other locking devices are available on request.
- Turnbuckles can be supplied with turning wheel or ratchet on request.
- Sizes other than standard are possible on request.

**WE WELCOME ALL ENQUIRIES FOR CUSTOM
DESIGNED SOLUTIONS. PLEASE CONTACT YOUR
SALES REPRESENTATIVE FOR FURTHER INFORMATION.**

TURNBUCKLES WITH TRAPEZOID THREAD; JAW - JAW

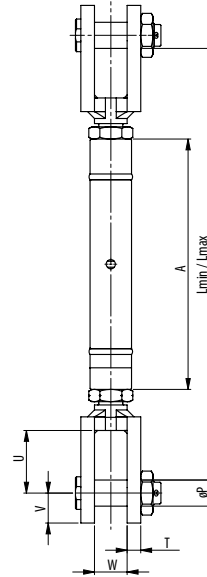

Model No.	WLL (UStons)	L min (inch)	L max (inch)	Take-up (inch)	Thread (trap.)	Dimensions (inch)						Weight (lbs)
						A	øP	U	V	W	T	
SPS TR.22.188.1,6J-J	1.7	15.67	22.24	6.57	22 x 5	9.45	0.79	2.17	0.89	0.91	0.43	7
SPS TR.24.200.2J-J	2.2	16.61	23.74	7.13	24 x 5	10.24	0.87	2.28	0.98	1.02	0.47	9
SPS TR.28.206.2,5J-J	2.7	20.16	28.62	8.46	28 x 5	11.02	0.94	2.87	1.08	1.18	0.47	13
SPS TR.30.228.3,1J-J	3.4	21.38	30.24	8.86	30 x 6	11.81	1.06	3.15	1.18	1.26	0.59	20
SPS TR.32.241.4J-J	4.4	22.99	32.13	9.13	32 x 6	12.60	1.18	3.39	1.28	1.38	0.59	22
SPS TR.36.240.5J-J	5.5	24.09	33.62	9.53	36 x 6	13.39	1.42	3.66	1.48	1.57	0.79	33
SPS TR.44.263.6,3J-J	6.9	27.60	38.23	10.63	44 x 7	14.96	1.54	4.25	1.67	1.77	0.79	44
SPS TR.48.297.8J-J	8.8	29.72	41.38	11.65	48 x 8	16.54	1.77	4.41	1.87	1.97	0.98	62
SPS TR.52.309.10J-J	11.0	31.42	43.46	12.05	52 x 8	18.11	1.89	4.53	2.17	2.36	0.98	77
SPS TR.55.340.12,6J-J	13.8	33.94	47.80	13.86	55 x 9	19.69	2.05	4.80	2.36	2.56	1.18	104
SPS TR.65.354.16J-J	17.6	37.17	51.57	14.41	65 x 10	21.26	2.36	5.12	2.56	2.76	1.18	137
SPS TR.70.382.20J-J	22.0	41.02	55.98	14.96	70 x 10	22.83	2.68	5.71	2.76	2.95	1.38	187
SPS TR.75.404.25J-J	27.5	44.33	60.16	15.83	75 x 10	24.41	2.83	6.30	2.95	3.15	1.38	220
SPS TR.80.430.31,5J-J	34.7	46.93	64.17	17.24	80 x 10	25.98	3.15	6.69	3.35	3.54	1.57	287
SPS TR.90.495.40J-J	44.0	50.39	68.66	18.27	90 x 10	27.36	3.54	7.48	3.62	3.94	1.77	386
SPS TR.100.550.50J-J	55.1	54.72	75.20	20.47	100 x 10	30.31	3.94	8.07	4.13	4.33	1.97	520
SPS TR.110.605.63J-J	69.4	60.08	82.28	22.20	110 x 10	33.66	4.33	8.66	4.41	4.72	2.36	717
SPS TR.120.660.80J-J	88.1	65.08	89.88	24.80	120 x 10	36.22	4.92	9.25	5.00	5.51	2.76	996
SPS TR.130.715.100J-J	110.2	68.82	97.17	28.35	130 x 10	39.17	5.51	9.84	5.59	6.14	2.76	1272
SPS TR.140.770.125J-J	137.7	74.80	104.41	29.61	140 x 10	42.13	6.30	10.63	6.38	6.93	3.15	1788
SPS TR.160.880.160J-J	176.3	82.28	116.93	34.65	160 x 10	48.03	7.09	11.42	7.17	7.87	3.54	2469

Minimum Ultimate Strength = 5 x WLL

- Standard painted blue, but can be supplied in any color or galvanized.
- Available in all combinations of eyes, stud eyes and welding ends.
- Factory supplied with lock nuts.
- Lock plates or special locking devices possible.
- Can be supplied with turning wheel or ratchet.
- Other sizes possible.
- Straight or in-line pull only.



TURNBUCKLES WITH TRAPEZOID THREAD; STUD EYE - STUD EYE

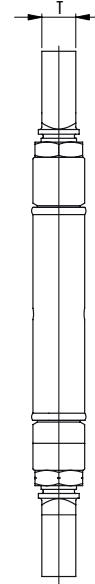
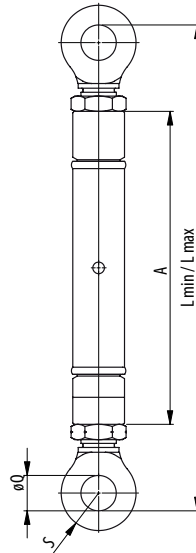

Model No.	WLL (UStons)	L min (inch)	L max (inch)	Take-up (inch)	Thread (trap.)	Dimensions (inch)				Weight (lbs)
						A	øQ	S	T	
SPS TR.22.188.1,6.E-E	1.7	13.74	20.31	6.57	22 x 5	9.45	0.91	0.89	0.79	4
SPS TR.24.200.2.E-E	2.2	14.84	21.97	7.13	24 x 5	10.24	0.98	0.98	0.87	7
SPS TR.28.206.2,5.E-E	2.7	16.18	24.65	8.46	28 x 5	11.02	1.06	1.08	0.98	11
SPS TR.30.228.3,1.E-E	3.4	17.91	26.77	8.86	30 x 6	11.81	1.18	1.18	1.10	11
SPS TR.32.241.4.E-E	4.4	18.66	27.80	9.13	32 x 6	12.60	1.30	1.28	1.18	13
SPS TR.36.240.5.E-E	5.5	21.10	30.63	9.53	36 x 6	13.39	1.54	1.48	1.38	24
SPS TR.44.263.6,3.E-E	6.9	22.80	33.43	10.63	44 x 7	14.96	1.65	1.67	1.57	26
SPS TR.48.297.8.E-E	8.8	25.87	37.52	11.65	48 x 8	16.54	1.89	1.87	1.77	35
SPS TR.52.309.10.E-E	11.0	28.11	40.16	12.05	52 x 8	18.11	2.05	2.17	1.97	51
SPS TR.55.340.12,6.E-E	13.8	30.00	43.86	13.86	55 x 9	19.69	2.20	2.36	2.17	88
SPS TR.65.354.16.E-E	17.6	33.86	48.27	14.41	65 x 10	21.26	2.56	2.56	2.36	121
SPS TR.70.382.20.E-E	22.0	35.59	50.55	14.96	70 x 10	22.83	2.91	2.76	2.56	152
SPS TR.75.404.25.E-E	27.5	38.27	54.09	15.83	75 x 10	24.41	3.07	2.95	2.76	137
SPS TR.80.430.31,5.E-E	34.7	40.87	58.11	17.24	80 x 10	25.98	3.39	3.35	3.15	172
SPS TR.90.495.40.E-E	44.0	46.69	64.96	18.27	90 x 10	27.36	3.78	3.74	3.54	300
SPS TR.100.550.50.E-E	55.1	50.63	71.10	20.47	100 x 10	30.31	4.17	4.13	3.94	353
SPS TR.110.605.63.E-E	69.4	55.35	77.56	22.20	110 x 10	33.27	4.57	4.53	4.33	485
SPS TR.120.660.80.E-E	88.1	60.67	85.47	24.80	120 x 10	36.22	5.16	5.31	4.92	617
SPS TR.130.715.100.E-E	110.2	65.43	93.78	28.35	130 x 10	39.17	5.75	5.83	5.51	816
SPS TR.140.770.125.E-E	137.7	71.02	100.63	29.61	140 x 10	42.13	6.61	6.61	6.30	1102
SPS TR.160.880.160.E-E	176.3	79.84	114.49	34.65	160 x 10	48.03	7.40	7.48	7.09	1598

Minimum Ultimate Strength = 5 x WLL

- Standard painted blue, but can be supplied in any color or galvanized.
- Available in all combinations of eyes, stud eyes and welding ends.
- Factory supplied with lock nuts.
- Lock plates or special locking devices possible.
- Can be supplied with turning wheel or ratchet.
- Other sizes possible.
- Straight or in-line pull only.



TURNBUCKLES WITH TRAPEZOID THREAD; JAW - STUD EYE

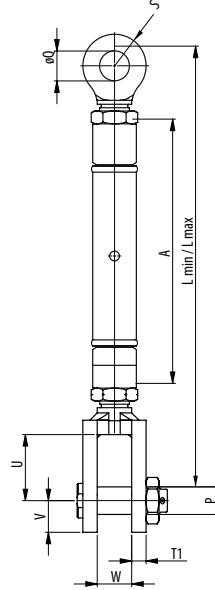

Model No.	WLL (UStons)	L min (inch)	L max (inch)	Take-up (inch)	Thread (trap.)	Dimensions (inch)									Weight (lbs)
						A	øP	øQ	S	T	T1	U	V	W	
SPS TR.22.188.1,6-J-E	1.7	14.45	21.02	6.57	22 x 5	9.45	0.79	0.91	0.89	0.79	2.17	0.87	0.91	23	4
SPS TR.24.200.2-J-E	2.2	15.55	22.68	7.13	24 x 5	10.24	0.87	0.98	0.98	0.87	2.28	0.98	1.02	26	7
SPS TR.28.206.2,5-J-E	2.7	18.07	26.54	8.46	28 x 5	11.02	0.94	1.06	1.08	0.98	2.87	1.06	1.18	30	11
SPS TR.30.228.3,1-J-E	3.4	19.65	28.50	8.86	30 x 6	11.81	1.06	1.18	1.18	1.10	3.15	1.18	1.26	32	15
SPS TR.32.241.4-J-E	4.4	20.83	29.96	9.13	32 x 6	12.60	1.18	1.30	1.28	1.18	3.39	1.26	1.38	35	18
SPS TR.36.240.5-J-E	5.5	22.60	32.13	9.53	36 x 6	13.39	1.42	1.54	1.48	1.38	3.66	1.46	1.57	40	26
SPS TR.44.263.6,3-J-E	6.9	25.20	35.83	10.63	44 x 7	14.96	1.54	1.65	1.67	1.57	4.25	1.65	1.77	45	35
SPS TR.48.297.8-J-E	8.8	27.80	39.45	11.65	48 x 8	16.54	1.77	1.89	1.87	1.77	4.41	1.85	1.97	50	49
SPS TR.52.309.10-J-E	11.0	29.76	41.81	12.05	52 x 8	18.11	1.89	2.05	2.17	1.97	4.53	2.17	2.36	60	64
SPS TR.55.340.12,6-J-E	13.8	31.97	45.83	13.86	55 x 9	19.69	2.05	2.20	2.36	2.17	4.80	2.36	2.56	65	97
SPS TR.65.354.16-J-E	17.6	35.51	49.92	14.41	65 x 10	21.26	2.36	2.56	2.56	2.36	5.12	2.56	2.76	70	112
SPS TR.70.382.20-J-E	22.0	37.68	52.64	14.96	70 x 10	22.83	2.68	2.91	2.76	2.56	5.71	2.76	2.95	75	163
SPS TR.75.404.25-J-E	27.5	41.30	57.13	15.83	75 x 10	24.41	2.83	3.07	2.95	2.76	6.30	2.95	3.15	80	179
SPS TR.80.430.31,5-J-E	34.7	43.90	61.14	17.24	80 x 10	25.98	3.15	3.39	3.35	3.15	6.69	3.35	3.54	90	229
SPS TR.90.495.40-J-E	44.0	48.43	66.69	18.27	90 x 10	27.36	3.54	3.78	3.74	3.54	7.48	3.62	3.94	100	344
SPS TR.100.550.50-J-E	55.1	52.56	73.03	20.47	100 x 10	30.31	3.94	4.17	4.13	3.94	8.07	4.13	4.33	110	441
SPS TR.110.605.63-J-E	69.4	57.60	79.80	22.20	110 x 10	33.66	4.33	4.57	4.53	4.33	8.66	4.41	4.72	120	639
SPS TR.120.660.80-J-E	88.1	62.76	87.56	24.80	120 x 10	36.22	4.92	5.16	5.31	4.92	9.25	5.00	5.51	140	772
SPS TR.130.715.100-J-E	110.2	67.01	95.35	28.35	130 x 10	39.17	5.51	5.75	5.83	5.51	9.84	5.59	6.14	156	970
SPS TR.140.770.125-J-E	137.7	72.36	101.97	29.61	140 x 10	42.13	6.30	6.61	6.61	6.30	10.63	6.38	6.93	176	1455
SPS TR.160.880.160-J-E	176.3	80.94	115.59	34.65	160 x 10	48.03	7.09	7.40	7.48	7.09	11.42	7.17	7.87	200	2039

Minimum Ultimate Strength = 5 x WLL

- Standard painted blue, but can be supplied in any color or galvanized.
- Available in all combinations of eyes, stud eyes and welding ends.
- Factory supplied with lock nuts.
- Lock plates or special locking devices possible.
- Can be supplied with turning wheel or ratchet.
- Other sizes possible.
- Straight or in-line pull only.



TURNBUCKLES WITH TRAPEZOID THREAD; OBLONG EYE - OBLONG EYE

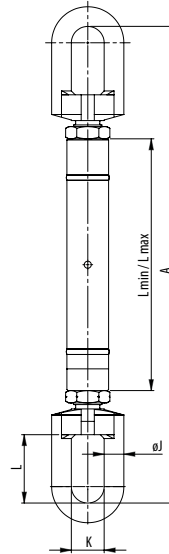

Model No.	WLL (UStons)	L min (inch)	L max (inch)	Take-up (inch)	Thread (trap.)	Dimensions (inch)				Weight (lbs)
						A	ø	K	L	
SPS TR.22.188.1,6.O-O	1.7	17.72	24.29	6.57	22 x 5	9.45	0.63	1.02	2.28	4
SPS TR.24.200.2.O-O	2.2	18.50	25.63	7.13	24 x 5	10.24	0.63	1.02	2.28	7
SPS TR.28.206.2,5.O-O	2.7	21.02	29.49	8.46	28 x 5	11.02	0.79	1.26	2.83	11
SPS TR.30.228.3,1.O-O	3.4	21.81	30.67	8.86	30 x 6	11.81	0.79	1.26	2.83	13
SPS TR.32.241.4.O-O	4.4	24.80	33.94	9.13	32 x 6	12.60	0.98	1.57	3.70	18
SPS TR.36.240.5.O-O	5.5	25.91	35.43	9.53	36 x 6	13.39	0.98	1.57	3.70	29
SPS TR.44.263.6,3.O-O	6.9	29.65	40.28	10.63	44 x 7	14.96	1.18	1.77	4.25	42
SPS TR.48.297.8.O-O	8.8	32.01	43.66	11.65	48 x 8	16.54	1.26	1.97	4.53	60
SPS TR.52.309.10.O-O	11.0	34.09	46.14	12.05	52 x 8	18.11	1.42	2.36	4.92	55
SPS TR.55.340.12,6.O-O	13.8	38.90	52.76	13.86	55 x 9	19.69	1.57	2.56	5.67	101
SPS TR.65.354.16.O-O	17.6	42.13	56.54	14.41	65 x 10	21.26	1.77	2.76	6.42	106
SPS TR.70.382.20.O-O	22.0	45.51	60.47	14.96	70 x 10	22.83	2.17	2.95	6.61	143
SPS TR.75.404.25.O-O	27.5	50.00	65.83	15.83	75 x 10	24.41	2.36	3.15	7.56	198
SPS TR.80.430.31,5.O-O	34.7	53.46	70.71	17.24	80 x 10	25.98	2.36	3.54	8.50	207

Minimum Ultimate Strength = 5 x WLL

- Standard painted blue, but can be supplied in any color or galvanized.
- Available in all combinations of eyes, stud eyes and welding ends.
- Factory supplied with lock nuts.
- Lock plates or special locking devices possible.
- Can be supplied with turning wheel or ratchet.
- Other sizes possible.
- Straight or in-line pull only.



TURNBUCKLES WITH TRAPEZOID THREAD; JAW - OBLONG EYE

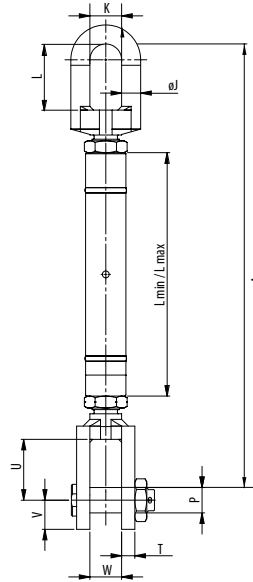

Model No.	WLL (UStons)	L min (inch)	L max (inch)	Take-up (inch)	Thread (trap.)	Dimensions (inch)								Weight (lbs)	
						A	J	K	L	øP	T	U	V		W
SPS TR.22.188.1,6J-O	1.7	16.42	22.99	6.57	22 x 5	9.45	0.63	1.02	2.28	0.79	2.17	0.89	0.91	23	7
SPS TR.24.200.2J-O	2.2	17.36	24.49	7.13	24 x 5	10.24	0.63	1.02	2.28	0.87	2.28	0.98	1.02	26	9
SPS TR.28.206.2,5J-O	2.7	20.59	29.06	8.46	28 x 5	11.02	0.79	1.26	2.83	0.94	2.87	1.08	1.18	30	13
SPS TR.30.228.3,1J-O	3.4	21.61	30.47	8.86	30 x 6	11.81	0.79	1.26	2.83	1.06	3.15	1.18	1.26	32	15
SPS TR.32.241.4J-O	4.4	23.90	33.03	9.13	32 x 6	12.60	0.98	1.57	3.70	1.18	3.39	1.28	1.38	35	20
SPS TR.36.240.5J-O	5.5	24.96	34.49	9.53	36 x 6	13.39	0.98	1.57	3.70	1.42	3.66	1.48	1.57	40	31
SPS TR.44.263.6,3J-O	6.9	28.50	39.13	10.63	44 x 7	14.96	1.18	1.77	4.25	1.54	4.25	1.67	1.77	45	44
SPS TR.48.297.8J-O	8.8	30.63	42.28	11.65	48 x 8	16.54	1.26	1.97	4.53	1.77	4.41	1.87	1.97	50	64
SPS TR.52.309.10J-O	11.0	32.76	44.80	12.05	52 x 8	18.11	1.42	2.36	4.92	1.89	4.53	2.17	2.36	60	66
SPS TR.55.340.12,6J-O	13.8	36.42	50.28	13.86	55 x 9	19.69	1.57	2.56	5.67	2.05	4.80	2.36	2.56	65	106
SPS TR.65.354.16J-O	17.6	39.65	54.06	14.41	65 x 10	21.26	1.77	2.76	6.42	2.36	5.12	2.56	2.76	70	121
SPS TR.70.382.20J-O	22.0	43.27	58.23	14.96	70 x 10	22.83	2.17	2.95	6.61	2.68	5.71	2.76	2.95	75	165
SPS TR.75.404.25J-O	27.5	46.34	62.17	15.83	75 x 10	24.41	2.36	3.15	7.56	2.83	6.30	2.95	3.15	80	207
SPS TR.80.430.31,5J-O	34.7	50.20	67.44	17.24	80 x 10	25.98	2.36	3.54	8.50	3.15	6.69	3.35	3.54	90	247

Minimum Ultimate Strength = 5 x WLL

- Standard painted blue, but can be supplied in any color or galvanized.
- Available in all combinations of eyes, stud eyes and welding ends.
- Factory supplied with lock nuts.
- Lock plates or special locking devices possible.
- Can be supplied with turning wheel or ratchet.
- Other sizes possible.
- Straight or in-line pull only.



TURNBUCKLES WITH TRAPEZOID THREAD; OBLONG EYE - STUD EYE

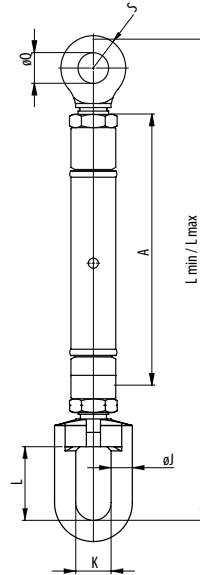

Model No.	WLL (UStons)	L min (inch)	L max (inch)	Take-up (inch)	Thread (trap.)	Dimensions (inch)							Weight (lbs)
						A	øJ	K	L	øQ	S	T	
SPS TR.22.188.1,6.O-E	1.7	15.75	22.32	6.57	22 x 5	9.45	0.63	1.02	2.28	0.91	0.89	0.79	4
SPS TR.24.200.2.O-E	2.2	16.69	23.82	7.13	24 x 5	10.24	0.63	1.02	2.28	0.98	0.98	0.87	7
SPS TR.28.206.2,5.O-E	2.7	18.70	27.17	8.46	28 x 5	11.02	0.79	1.26	2.83	1.06	1.08	0.98	11
SPS TR.30.228.3,1.O-E	3.4	19.88	28.74	8.86	30 x 6	11.81	0.79	1.26	2.83	1.18	1.18	1.10	13
SPS TR.32.241.4.O-E	4.4	21.73	30.87	9.13	32 x 6	12.60	0.98	1.57	3.70	1.30	1.28	1.18	15
SPS TR.36.240.5.O-E	5.5	23.03	32.56	9.53	36 x 6	13.39	0.98	1.57	3.70	1.54	1.48	1.38	26
SPS TR.44.263.6,3.O-E	6.9	26.18	36.81	10.63	44 x 7	14.96	1.18	1.77	4.25	1.65	1.67	1.57	37
SPS TR.48.297.8.O-E	8.8	28.50	40.16	11.65	48 x 8	16.54	1.26	1.97	4.53	1.89	1.87	1.77	55
SPS TR.52.309.10.O-E	11.0	31.10	43.15	12.05	52 x 8	18.11	1.42	2.36	4.92	2.05	2.17	1.97	53
SPS TR.55.340.12,6.O-E	13.8	34.45	48.31	13.86	55 x 9	19.69	1.57	2.56	5.67	2.20	2.36	2.17	93
SPS TR.65.354.16.O-E	17.6	37.99	52.40	14.41	65 x 10	21.26	1.77	2.76	6.42	2.56	2.56	2.36	97
SPS TR.70.382.20.O-E	22.0	41.10	56.06	14.96	70 x 10	22.83	2.17	2.95	6.61	2.91	2.76	2.56	157
SPS TR.75.404.25.O-E	27.5	44.06	59.88	15.83	75 x 10	24.41	2.36	3.15	7.56	3.07	2.95	2.76	181
SPS TR.80.430.31,5.O-E	34.7	47.17	64.41	17.24	80 x 10	25.98	2.36	3.54	8.50	3.39	3.35	3.15	190

Minimum Ultimate Strength = 5 x WLL

- Standard painted blue, but can be supplied in any color or galvanized.
- Available in all combinations of eyes, stud eyes and welding ends.
- Factory supplied with lock nuts.
- Lock plates or special locking devices possible.
- Can be supplied with turning wheel or ratchet.
- Other sizes possible.
- Straight or in-line pull only.

