

Material : Alloy steel
 Finish : Zinc painted

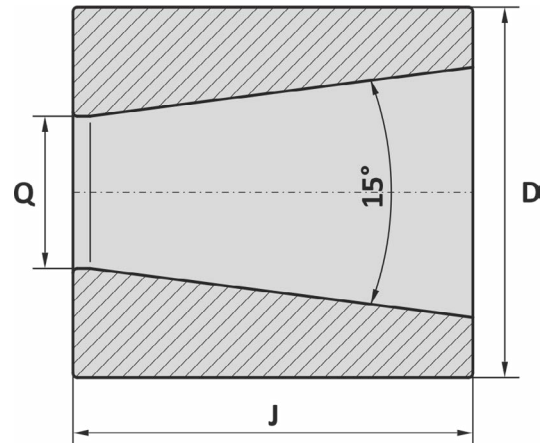

Art. No.	Rope inch	Strand dia min inch	Strand dia max inch	MBL ton	D inch	J inch	Q inch	Weight lbs
47800012	1 ⁵ / ₃₂	1 ⁵ / ₃₂	1/2	17	2 3/4	2 7/8	7/8	2.4
47800016	5/8	9/16	5/8	26	2 15/16	3 1/16	1	4.0
47800019	3/4	11/16	3/4	32	3 5/32	4 3/16	1 1/32	5.5
47800026	1 1/32	25/32	29/32	70	3 7/16	4 7/8	1 7/32	7.9
47800028	1 3/32	29/32	1 1/32	100	3 15/16	5 1/16	1 3/8	11
47800032	1 1/4	1 1/16	1 1/8	125	4 1/8	5 7/8	1 1/2	13
47800035	1 3/8	1 3/16	1 1/4	125	3 15/16	5 1/4	1 3/8	10
47800038	1 1/2	1 5/16	1 3/8	150	4 1/8	5 1/2	1 3/4	11
47800042	1 21/32	1 13/32	1 1/2	200	4 5/16	5 3/4	1 27/32	13
47800045	1 25/32	1 17/32	1 21/32	260	4 23/32	6	1 31/32	17
47800051	2	1 11/16	1 25/32	280	5 1/8	6 1/4	2 1/8	20
47800054	2 1/8	1 13/16	1 7/8	280	5 1/2	6 1/2	2 5/32	24
47800057	2 1/4	1 15/16	2	360	5 29/32	6 25/32	2 13/32	31
47800060	2 3/8	2 1/16	2 1/8	360	6 3/16	7	2 1/2	37
47800063	2 19/32	2 5/32	2 9/32	450	6 11/16	7 1/4	2 3/4	44
47800067	2 5/8	2 5/16	2 3/8	480	7 3/32	7 15/32	2 7/8	53
47800073	2 7/8	2 13/32	2 9/16	480	7 15/32	7 3/4	2 15/16	62
47800076	3	2 19/32	2 3/4	520	8 1/4	8 1/8	3 5/32	77
47800083	3 1/4	2 13/16	3	600	8 23/32	8 7/8	3 3/8	99
47800089	3 1/2	3 1/8	3 1/4	700	9 27/32	9 3/4	3 25/32	130
47800095	3 3/4	3 11/32	3 5/16	875	10 1/4	10 3/8	4	161
47800102	4	3 3/8	3 25/32	875	11 1/32	11 1/8	4 1/4	194
47800108	4 1/4	3 7/8	4	1100	11 13/16	11 3/4	4 17/32	234
47800121	4 3/4	4 3/32	4 3/8	1250	11 13/16	11 3/4	5 5/32	227
47800133	5 1/4	4 1/2	4 3/4	1350	12 19/32	12 1/2	5 3/4	265
47800146	5 3/4	4 27/32	5 1/8	1350	13 3/8	13 3/4	6 1/4	340
47800152	6	5 1/4	5 1/2	1350	13 25/32	15	6 1/2	390

Tolerance: Machined parts ± 1/32 inch

22-06-2018