

Material : Cast steel  
 Safety factor : 4 times  
 Finish : Galvanized  
 Temperature range : -20°C up to +200°C  
 Standard certification : Certificate of Conformity

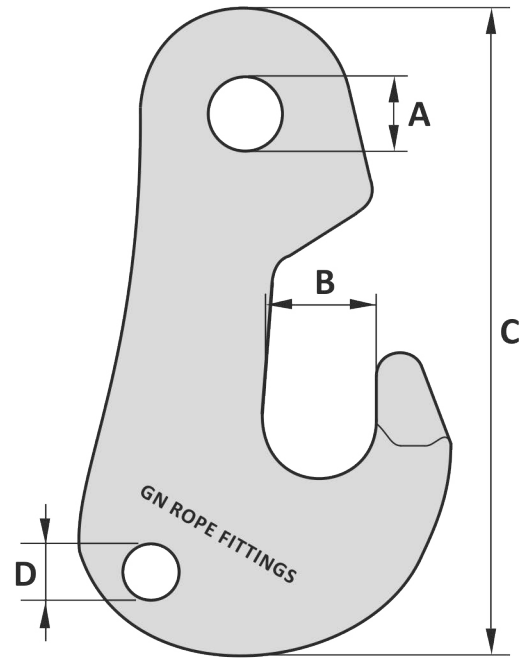
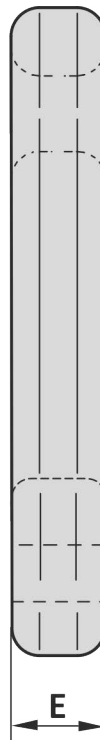
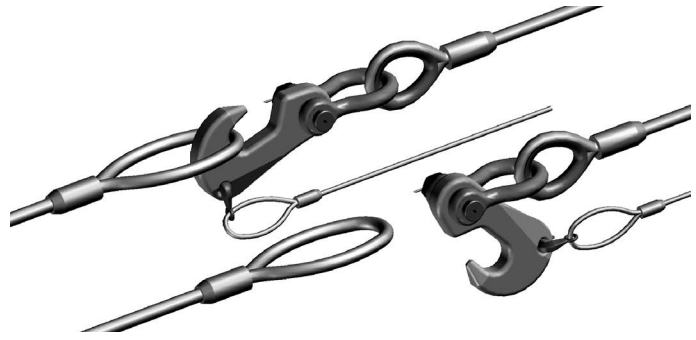

Art. No.	WLL ton	MBL ton	A mm	B mm	C mm	D mm	E mm	Weight kg
74000015	15	60	38	58	343	32	45	11
74000020	20	80	40	74	343	32	60	14
74000025	25	100	52	86	440	38	65	26
74000050	50	200	80	112	618	45	90	67
74000080	80	320	90	130	709	62	110	116

Tolerance: ± 5%

Art. No.	WLL ton	MBL ton	A inch	B inch	C inch	D inch	E inch	Weight lbs
74000015	15	60	1 ½	2 ½/₃₂	13 ½	1 ¼	1 25/₃₂	24
74000020	20	80	1 5/₁₆	2 29/₃₂	13 ½	1 ¼	2 3/₈	31
74000025	25	100	2 1/₁₆	3 3/₈	17 5/₁₆	1 ½	2 5/₁₆	57
74000050	50	200	3 5/₃₂	4 13/₃₂	24 5/₁₆	1 29/₃₂	3 3/₁₆	148
74000080	80	320	3 5/₁₆	5 1/₈	27 29/₃₂	2 7/₁₆	4 5/₁₆	256

Tolerance: ± 5%

01-07-2011