

Ductile cast iron Sheaves >>

with cylindrical roller bearings

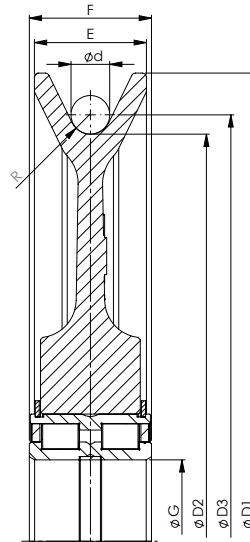

Model number	for wire ød		Dimensions (inch)							Bearing	Weight (kg)	Weight (lbs)
	mm	inch	R	D1	D2	D3	E	F	øG			
SE.250.5008B.5,5	10	3/8	0.22	11.42	9.84	10.24	1.26	1.50	1.57	SL04 5008PP	5.9	12.98
SE.250.5008B.6	11	7/16	0.24	11.42	9.84	10.28	1.26	1.50	1.57	SL04 5008PP	5.8	12.76
SE.280.5012.7	13	1/2	0.28	12.60	11.02	11.54	1.65	1.81	2.36	SL04 5012PP	9.4	20.68
SE.280.5010B.7	13	1/2	0.28	12.60	11.02	11.54	1.42	1.57	1.97	SL04 5010PP	8.1	17.82
SE.280.5010.7	13	1/2	0.28	12.60	11.02	11.54	1.42	1.57	1.97	SL04 5010PP	8.1	17.82
SE.250.5008B.7,2	13	1/2	0.28	11.42	9.84	10.35	1.26	1.50	1.57	SL04 5008PP	6.2	13.64
SE.260.5012.7,5	14	9/16	0.30	11.81	10.24	10.79	1.65	1.81	2.36	SL04 5012PP	9.6	21.12
SE.280.5012.8	15	9/16	0.31	12.60	11.02	11.61	1.65	1.81	2.36	SL04 5012PP	9.2	20.24
SE.400.5013.8,5	16	5/8	0.33	18.11	15.75	16.38	1.69	1.81	2.56	SL04 5013PP	25.4	55.88
SE.360.5016.8,5	16	5/8	0.33	16.54	14.17	14.80	2.17	2.36	3.15	SL04 5016PP	21.9	48.18
SE.355.5013.8,5	16	5/8	0.33	16.14	13.98	14.61	1.65	1.81	2.56	SL04 5013PP	18.3	40.26
SE.320.5013.8,5	16	5/8	0.33	14.37	12.60	13.23	1.65	1.81	2.56	SL04 5013PP	13.5	29.7
SE.295.5008B.8,5	16	5/8	0.33	12.99	11.61	12.24	1.26	1.50	1.57	SL04 5008PP	8.8	19.36
SE.280.5012.8,5	16	5/8	0.33	12.60	11.02	11.65	1.65	1.81	2.36	SL04 5012PP	9.1	20.02
SE.260.5012.8,5	16	5/8	0.33	11.81	10.24	10.87	1.65	1.81	2.36	SL04 5012PP	9.1	20.02
SE.355.5013.9	17	11/16	0.35	16.14	13.98	14.65	1.65	1.81	2.56	SL04 5013PP	18.1	39.82
SE.400.5014B.9,5	18	11/16	0.37	18.11	15.75	16.46	1.93	2.13	2.76	SL04 5014PP	25.4	55.88
SE.400.5013.9,5	18	11/16	0.37	18.11	15.75	16.46	1.69	1.81	2.56	SL04 5013PP	25	55
SE.360.5016.9,5	18	11/16	0.37	16.54	14.17	14.88	2.17	2.36	3.15	SL04 5016PP	21.6	47.52
SE.355.5013.9,5	18	11/16	0.37	16.14	13.98	14.69	1.65	1.81	2.56	SL04 5013PP	18	39.6
SE.354.5013.9,5	18	11/16	0.37	15.75	13.94	14.65	1.65	1.81	2.56	SL04 5013PP	16.5	36.3
SE.345.5010B.9,5	18	11/16	0.37	15.16	13.58	14.29	1.42	1.57	1.97	SL04 5010PP	12.5	27.5
SE.450.5024.10	19	3/4	0.39	20.28	17.72	18.46	2.95	3.15	4.72	SL04 5024PP	47.9	105.38
SE.450.5018.10	19	3/4	0.39	20.28	17.72	18.46	2.44	2.64	3.54	SL04 5018PP	41.4	91.08
SE.450.160.10	19	3/4	0.39	20.28	17.72	18.46	2.95	3.15	6.30	SL04 160PP	45.4	99.88

- The dimensions in this table are indicative only. A drawing will always be submitted prior to production and will be the leading document when discussing dimensions.
- Sheaves shown here are standard models; inquiries for custom versions are welcome.



SEE OUR WARNINGS AND APPLICATION INSTRUCTIONS

<< Ductile cast iron Sheaves

with cylindrical roller bearings

Model number	for wire ød		Dimensions (inch)							Bearing	Weight (kg)	Weight (lbs)
	mm	inch	R	D1	D2	D3	E	F	øG			
SE.400.5018.10	19	¾	0.39	18.11	15.75	16.50	2.44	2.64	3.54	SL04 5018PP	31	68.2
SE.400.5016.10	19	¾	0.39	18.11	15.75	16.50	2.17	2.36	3.15	SL04 5016PP	28.8	63.36
SE.400.5013.10	19	¾	0.39	18.11	15.75	16.50	1.69	1.81	2.56	SL04 5013PP	24.8	54.56
SE.360.5016.10	19	¾	0.39	16.54	14.17	14.92	2.17	2.36	3.15	SL04 5016PP	17.9	39.38
SE.355.5016.10	19	¾	0.39	16.14	13.98	14.72	2.17	2.36	3.15	SL04 5016PP	16.8	36.96
SE.355.5013.10	19	¾	0.39	16.14	13.98	14.72	1.65	1.81	2.56	SL04 5013PP	17.8	39.16
SE.345.5010B.10	19	¾	0.39	15.16	13.58	14.33	1.42	1.57	1.97	SL04 5010PP	12.5	27.5
SE.320.5013.10	19	¾	0.39	14.37	12.60	13.35	1.65	1.81	2.56	SL04 5013PP	13.2	29.04
SE.280.5012.10	19	¾	0.39	12.60	11.02	11.77	1.65	1.81	2.36	SL04 5012PP	10.3	22.66
SE.482.5018.11,5	21	13/16	0.45	22.05	18.98	19.80	2.44	2.64	3.54	SL04 5018PP	45.5	100.1
SE.400.5018.11,5	21	13/16	0.45	18.11	15.75	16.57	2.44	2.64	3.54	SL04 5018PP	30.4	66.88
SE.400.5016.11,5	21	13/16	0.45	18.11	15.75	16.57	2.17	2.36	3.15	SL04 5016PP	28.3	62.26
SE.400.5014B.11,5	21	13/16	0.45	18.11	15.75	16.57	1.93	2.13	2.76	SL04 5014PP	24.7	54.34
SE.450.5024.12	22	7/8	0.47	20.28	17.72	18.58	2.95	3.15	4.72	SL04 5024PP	47	103.4
SE.450.5018.12	22	7/8	0.47	20.28	17.72	18.58	2.44	2.64	3.54	SL04 5018PP	40.5	89.1
SE.400.5018.12	22	7/8	0.47	18.11	15.75	16.61	2.44	2.64	3.54	SL04 5018PP	30.2	66.44
SE.400.5016.12	22	7/8	0.47	18.11	15.75	16.61	2.17	2.36	3.15	SL04 5016PP	28.1	61.82
SE.355.5016.12	22	7/8	0.47	16.14	13.98	14.84	2.17	2.36	3.15	SL04 5016PP	16.8	36.96
SE.528.5018.13	24	15/16	0.51	23.43	20.79	21.73	2.40	2.64	3.54	SL04 5018PP	50.9	111.98
SE.528.200.13	24	15/16	0.51	23.43	20.79	21.73	2.91	3.15	7.87	SL04 200PP	56.7	124.74
SE.528.160.13	24	15/16	0.51	23.43	20.79	21.73	2.91	3.15	6.30	SL04 160PP	61.2	134.64
SE.670.200.13,5	25	1	0.53	29.92	26.38	27.36	2.91	3.15	7.87	SL04 200PP	93.5	205.7
SE.670.160.13,5	25	1	0.53	29.92	26.38	27.36	2.91	3.15	6.30	SL04 160PP	93.5	205.7
SE.670.5024.13,5	25	1	0.53	29.92	26.38	27.36	2.91	3.15	4.72	SL04 5024PP	92.6	203.72
SE.528.5024.13,5	25	1	0.53	23.43	20.79	21.77	2.91	3.15	4.72	SL04 5024PP	57.8	127.16
SE.528.5018.13,5	25	1	0.53	23.43	20.79	21.77	2.40	2.64	3.54	SL04 5018PP	50.6	111.32
SE.528.160.13,5	25	1	0.53	23.43	20.79	21.77	2.91	3.15	6.30	SL04 160PP	53.5	117.7
SE.500.5018B.13,5	25	1	0.53	22.44	19.69	20.71	2.40	2.64	3.54	SL04 5018PP	46.8	102.96
SE.450.5024.13,5	25	1	0.53	20.28	17.72	18.70	2.95	3.15	4.72	SL04 5024PP	46.3	101.86
SE.450.5018.13,5	25	1	0.53	20.28	17.72	18.70	2.44	2.64	3.54	SL04 5018PP	39.8	87.56
SE.575.5024.14	26	1	0.55	25.59	22.64	23.66	2.91	3.15	4.72	SL04 5024PP	72.6	159.72
SE.575.5022.14	26	1	0.55	25.59	22.64	23.66	2.91	3.15	4.33	SL04 5022PP	73.5	161.7
SE.575.200.14	26	1	0.55	25.59	22.64	23.66	2.91	3.15	7.87	SL04 200PP	76.7	168.74
SE.575.160.14	26	1	0.55	25.59	22.64	23.66	2.91	3.15	6.30	SL04 160PP	72	158.4
SE.528.5024.14	26	1	0.55	23.43	20.79	21.81	2.91	3.15	4.72	SL04 5024PP	63.5	139.7
SE.528.5018.14	26	1	0.55	23.43	20.79	21.81	2.40	2.64	3.54	SL04 5018PP	45.4	99.88
SE.528.160.14	26	1	0.55	23.43	20.79	21.81	2.91	3.15	6.30	SL04 160PP	53.2	117.04
SE.670.200.15	28	1 1/8	0.59	29.92	26.38	27.48	2.91	3.15	7.87	SL04 200PP	97	213.4
SE.670.160.15	28	1 1/8	0.59	29.92	26.38	27.48	2.91	3.15	6.30	SL04 160PP	92.2	202.84
SE.670.5024.15	28	1 1/8	0.59	29.92	26.38	27.48	2.91	3.15	4.72	SL04 5024PP	91.3	200.86
SE.630.200.15	28	1 1/8	0.59	27.95	24.80	25.91	2.91	3.15	7.87	SL04 200PP	87.7	192.94

- The dimensions in this table are indicative only. A drawing will always be submitted prior to production and will be the leading document when discussing dimensions.
- Sheaves shown here are standard models; inquiries for custom versions are welcome.



SEE OUR WARNINGS AND APPLICATION INSTRUCTIONS



<< Ductile cast iron Sheaves

with cylindrical roller bearings

Model number	for wire ød		Dimensions (inch)							Bearing	Weight (kg)	Weight (lbs)
	mm	inch	R	D1	D2	D3	E	F	øG			
SE.630.160.15	28	1 1/8	0.59	27.95	24.80	25.91	2.91	3.15	6.30	SL04 160PP	82.8	182.16
SE.630.5024.15	28	1 1/8	0.59	27.95	24.80	25.91	2.91	3.15	4.72	SL04 5024PP	84.4	185.68
SE.575.5024.15	28	1 1/8	0.59	25.59	22.64	23.74	2.91	3.15	4.72	SL04 5024PP	72	158.4
SE.575.200.15	28	1 1/8	0.59	25.59	22.64	23.74	2.91	3.15	7.87	SL04 200PP	76.1	167.42
SE.575.160.15	28	1 1/8	0.59	25.59	22.64	23.74	2.91	3.15	6.30	SL04 160PP	71.4	157.08
SE.528.5024.15	28	1 1/8	0.59	23.43	20.79	21.89	2.91	3.15	4.72	SL04 5024PP	57	125.4
SE.528.5018.15	28	1 1/8	0.59	23.43	20.79	21.89	2.40	2.64	3.54	SL04 5018PP	49.9	109.78
SE.528.200.15	28	1 1/8	0.59	23.43	20.79	21.89	2.91	3.15	7.87	SL04 200PP	64.9	142.78
SE.528.160.15	28	1 1/8	0.59	23.43	20.79	21.89	2.83	3.15	6.30	SL04 160PP	52.7	115.94
SE.450.5024.15	28	1 1/8	0.59	20.28	17.72	18.82	2.95	3.15	4.72	SL04 5024PP	45.6	100.32
SE.450.5018.15	28	1 1/8	0.59	20.28	17.72	18.82	2.44	2.64	3.54	SL04 5018PP	39.2	86.24
SE.630.200.16	30	1 3/8	0.63	27.95	24.80	25.98	2.91	3.15	7.87	SL04 200PP	87	191.4
SE.630.160.16	30	1 3/8	0.63	27.95	24.80	25.98	2.91	3.15	6.30	SL04 160PP	82.1	180.62
SE.630.5024.16	30	1 3/8	0.63	27.95	24.80	25.98	2.91	3.15	4.72	SL04 5024PP	83.7	184.14
SE.630.5022B.16	30	1 3/8	0.63	27.95	24.80	25.98	2.91	3.15	4.33	SL04 5022PP	83.5	183.7
SE.575.5022.16	30	1 3/8	0.63	25.59	22.64	23.82	2.91	3.15	4.33	SL04 5022PP	72.3	159.06
SE.800.5022.16	31	1 1/4	0.63	35.04	31.50	32.68	2.76	3.15	4.33	SL04 5022PP	136.5	300.3
SE.800.5026.17	32	1 1/4	0.67	35.04	31.50	32.76	2.95	3.74	5.12	SL04 5026PP	129.9	285.78
SE.710.5022.17	32	1 1/4	0.67	31.50	27.95	29.21	2.83	3.15	4.33	SL04 5022PP	99.8	219.56
SE.670.200.17	32	1 1/4	0.67	29.92	26.38	27.64	2.91	3.15	7.87	SL04 200PP	95.3	209.66
SE.670.160.17	32	1 1/4	0.67	29.92	26.38	27.64	2.91	3.15	6.30	SL04 160PP	90.5	199.1
SE.670.5024.17	32	1 1/4	0.67	29.92	26.38	27.64	2.91	3.15	4.72	SL04 5024PP	89.7	197.34
SE.630.200.17	32	1 1/4	0.67	27.95	24.80	26.06	2.91	3.15	7.87	SL04 200PP	86.3	189.86
SE.630.160.17	32	1 1/4	0.67	27.95	24.80	26.06	2.91	3.15	6.30	SL04 160PP	81.4	179.08
SE.630.5024.17	32	1 1/4	0.67	27.95	24.80	26.06	2.91	3.15	4.72	SL04 5024PP	83	182.6
SE.575.5024.17	32	1 1/4	0.67	25.59	22.64	23.90	2.91	3.15	4.72	SL04 5024PP	70.9	155.98
SE.710.5026.18	34	1 5/16	0.71	31.50	27.95	29.29	3.07	3.74	5.12	SL04 5026PP	98.3	216.26
SE.710.5022.18	34	1 5/16	0.71	31.50	27.95	29.29	2.83	3.15	4.33	SL04 5022PP	98.7	217.14
SE.800.5028.19	36	1 7/16	0.71	35.04	31.50	32.91	3.35	3.74	5.51	SL04 5028PP	152.4	335.28
SE.800.5030.20	38	1 1/2	0.71	35.04	31.50	32.99	3.54	3.94	5.91	SL04 5030PP	153	336.6
SE.800.5028.20	38	1 1/2	0.71	35.04	31.50	32.99	3.35	3.74	5.51	SL04 5028PP	151.4	333.08
SE.800.5026.20	38	1 1/2	0.71	35.04	31.50	32.99	2.95	3.74	5.12	SL04 5026PP	133.5	293.7
SE.800.5024.20	38	1 1/2	0.71	35.04	31.50	32.99	2.76	3.15	4.72	SL04 5024PP	127.1	279.62
SE.760.5030.20	38	1 1/2	0.71	33.86	29.92	31.42	3.35	3.94	5.91	SL04 5030PP	134.2	295.24
SE.710.5024.20	38	1 1/2	0.71	31.50	27.95	29.45	2.83	3.15	4.72	SL04 5024PP	94.5	207.9
SE.760.5026.20,5	39	1 9/16	0.81	33.86	29.92	31.46	2.95	3.74	5.12	SL04 5026PP	138.2	304.04
SE.800.5030.21	40	1 9/16	0.83	35.04	31.50	33.07	3.54	3.94	5.91	SL04 5030PP	152.4	335.28
SE.800.5028.21	40	1 9/16	0.83	35.04	31.50	33.07	3.35	3.74	5.51	SL04 5028PP	150.4	330.88
SE.800.5030.22,5	42	1 7/8	0.89	35.04	31.50	33.15	3.54	3.94	5.91	SL04 5030PP	160.1	352.22
SE.800.5028.22,5	42	1 7/8	0.89	35.04	31.50	33.15	3.35	3.74	5.51	SL04 5028PP	149	327.8
SE.800.5030.23,5	44	1 3/4	0.93	35.04	31.50	33.23	3.54	3.94	5.91	SL04 5030PP	149.6	329.12

- The dimensions in this table are indicative only. A drawing will always be submitted prior to production and will be the leading document when discussing dimensions.
- Sheaves shown here are standard models; inquiries for custom versions are welcome.



SEE OUR WARNINGS AND APPLICATION INSTRUCTIONS

